

Title: Addacabin Site Layout - First Floor (August 2006)

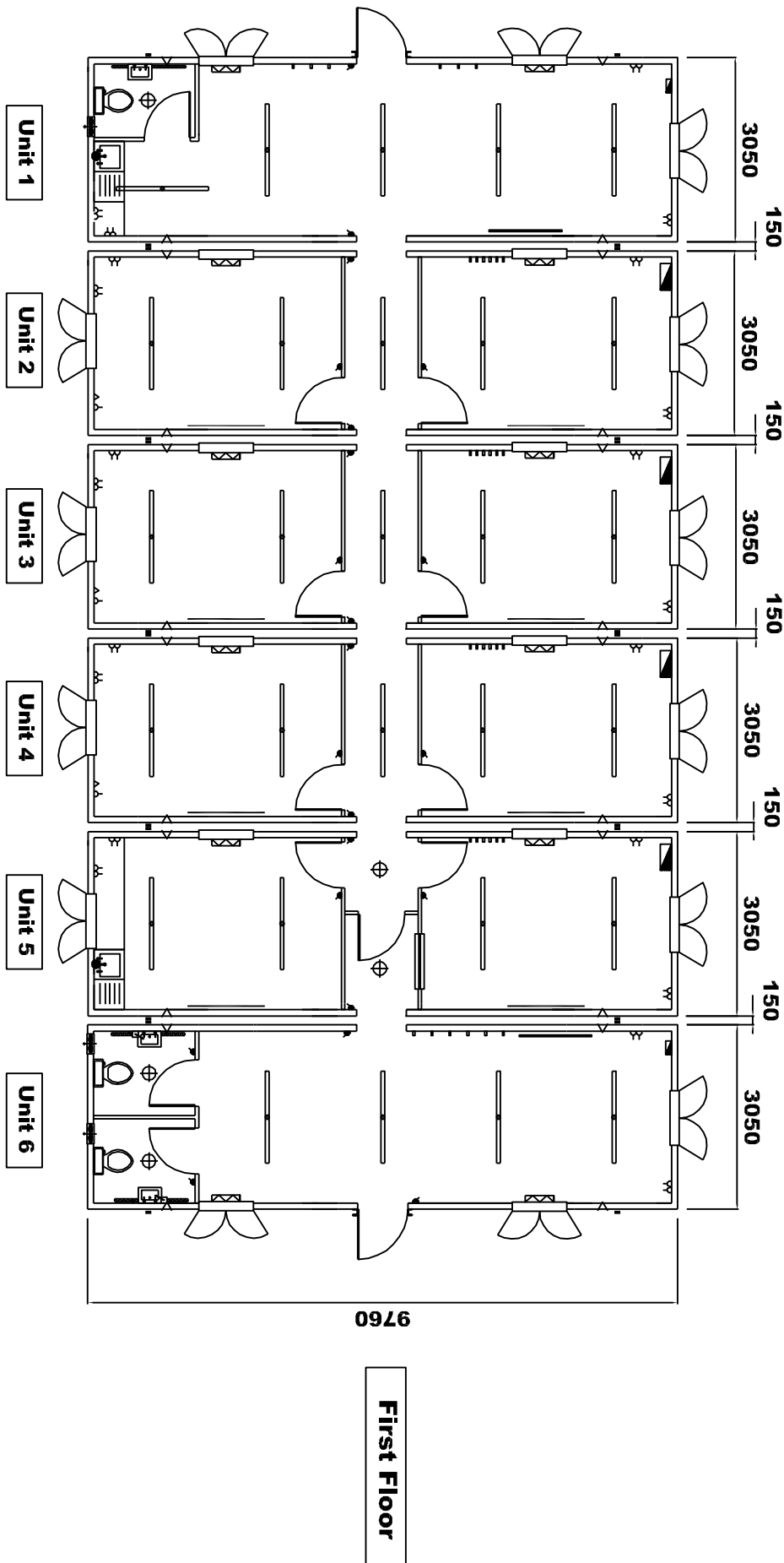

Drawing N°:	Adda Site Layout FF (Aug 06)	Amendments / Additions to Specification:
Job N°:		
Unit N°:		
Fleet N°:		
Wallboards:		
Flooring:		

NOTES

- All coathooks mounted on timber rails.
- Sockets above worktops - 1200mm FFL
- Standard Sockets - 300mm FFL
- Spurs for water heaters - 1500mm FFL
- Spurs for wall heaters - 300mm FFL
- Coathook Rails - 1695mm FFL (450mm FCL)
- Notice Boards - 1905mm FFL (240mm FCL)
- Vents - 240mm FFL

ISSUE	DATE	AMENDMENTS	DRAWN BY
1	31.08.06	First Issue	L. Wild
2			

STACKRIGHT BUILDING SYSTEMS

Chorleywood Road
 Knowsley Industrial
 Park North, Kirkby
 Merseyside L33 7SG
 Tel: 0151 548 3666
 Fax: 0151 548 3777
 Email: stockright.bs@btconnect.com